

Exhibit Directory



Dominick J. Capano
SMPTC Exhibit Chairman
(S.O.S. Photo-Cine-
Optics, Inc.)

EXHIBIT HOURS

Monday, Sept. 28..... 2:30-8:00

Tuesday, Sept. 29..... 11:00-8:00

Wednesday, Sept. 30..... 9:30-4:00

Thursday, Oct. 1..... 11:00-6:00

Admission to the Exhibit will be by Registration Badge or Exhibit Pass. Passes may be obtained free of charge at the Registration Desk.

Allen Products, Inc. Booth 4
986 Bridgeport Ave., Milford, Conn.

Exhibiting: New Model 205 Reversal Processor

Personnel: Harry Ormsbee, Irvin Heatherington, Dave Usher.

Amega Corp. Booth 19
11817 Wicks Street, Sun Valley, Calif.

Exhibiting: New models of magnetic film recorders, portable and studio rack mount, projector attachments, audio mixers, interlock & selsyn motor attachments and components. Model A-1 portable 16mm recorder with plug in interchangeable modules. Model M-2 recorder, two microphone input channels, power amplifier all transistorized. Model M-2 35mm recorder, portable or rack mount, featuring interchangeable head assembly with microphone preamplifier, record amplifier, playback preamplifier interchangeable with gain and equalization differences taking place at the receptacle. Model E-1 mixer, 4 channel microphone or bridge input with master gain 110-v AC or battery operated.

Personnel: William H. Stutz, Theodore Alexander.

Arriflex Corp. of America Booth 51, 52
257 Park Ave. South, New York, N.Y. 10010

Exhibiting: The complete Arriflex and Siemens lines, including the Arriflex-16S; the Arriflex-16M; the new Fibre Glass Blimp for the Arriflex-16M; the new 1200-ft coaxial magazine for the Arriflex-16M; the Siemens 2000 16/16 sound projector; the new Arriflex-35 model II C; a new special stand which makes possible the use of Arriflex-35 cameras with 100-ft Mitchell magazines, etc., etc..

Personnel: Paul Klingenstein, Victor James, Bruce Harris, Horst Bergmann.

Boston Insulated Wire & Cable Co. Booth 65
65 Bay Street, Boston 25, Mass.

Exhibiting: Bulk camera cable for all domestic and foreign cameras: RCA, GE, Marconi, Pye Ltd. and EMI camera cable in stock, black-and-white and color; assemblies of standard studio and conduit cables in cut lengths with connectors attached, black and white, and color; RCA and GE cable with LKT-type connectors matching all present cameras; Marconi, Pye Ltd. and EMI cable with

BIW TV-37C connectors attached mating with British cameras and connectors; CCTV and industrial camera cables of all types for your particular camera or application; Special cables for underwater use, radiation environments and other unusual applications.

Personnel: Hubert L. Goodwin, Alden C. Davis.

The Camera Mart, Inc. Booth 16, 17, 18
1845 Broadway, New York, N.Y. 10023

Exhibiting: Camart Dual Sound Readers; Camart Tightwind Adapter; Camart Triangles; Camart Core Dispensers; Camart Optical FX Unit; Camart Add-A-Plate Extension; Colortran lighting; Magnasync sound equipment; Preview Moviola; Closed-circuit sound TV system; completely equipped editing room with table, chairs, racks, bins, synchronizers, rewinds, etc.

Personnel: Herbert Browning, Robert Roizman, Irving Pivovar, "Chick" Hyman, Paul Meistrich.

Camera Service Center, Inc. Booth 41
333 West 52 St., New York, N.Y. 10019

Exhibiting: New Eclair 16mm NPR camera with built-in signal generator and accessories, featuring 400 ft. coaxial magazine, 60 cycle constant speed motor and 12/120 Angenieux Zoom lens; Mitchell Mark II Reflex camera with modifications featuring: top-mounted magazines and internal clutch design, an adapter door that permits the use of existing Mitchell-type motors, a new bayonet-type lens mount for rapid and sure lens change, a 4-stage sunshade and filter holder that can accommodate 4 filters simultaneously; Bell & Howell camera specially modified for reflex viewing with 35/140, Angenieux zoom lens and CSC wide-angle converter, changing the effective focal length of the zoom to 20mm to 90mm—24,28,50 and 75mm lenses also available; Super 4/12 Auricon Cine Voice Conversion with exclusive features.

Personnel: H. "Scoop" Clapp, Al Nathanson, Frank Riker, John Clapp, Jerry Pronovost, Jan Chyriuski.

Comprehensive Service Corp. Booth 59
245 West 55 St., New York, N.Y. 10019

Exhibiting: Reels, cans, cases; film handling, inspection and editing equipment and supplies; rejuvenation of color and

ADDITIVE COLOR PRINTING SYSTEM

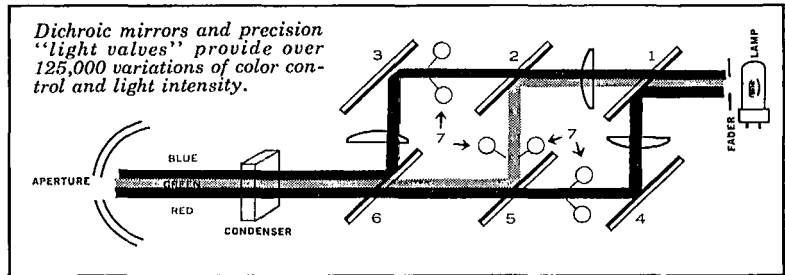

DICHROIC MIRROR	REFLECTS	TRANSMITS	DICHROIC MIRROR	REFLECTS	TRANSMITS
No. 1	RED	GREEN and BLUE	No. 4	RED only, reducing band width.	Unusable wave lengths
No. 2	RED and GREEN (Since red has already been removed from this beam, it reflects green only)	BLUE	No. 5	GREEN	RED
No. 3	BLUE only, further reducing band width.	Unusable wave lengths	No. 6	BLUE	RED and GREEN

No. 7 LIGHT VALVES

LIGHT VALVE CONTROL OF PRIMARY COLORS

A dichroic mirror system separates the single 1,000 watt light source into primary color beams. Each beam can be automatically varied by a "light valve" (no. 7 above) thru 50 steps of .025 log E. The simultaneous control of these "light valves" provides for color and light variations at the printing aperture.

With this new Bell & Howell color additive printing system, color corrections and fades, as well as "zero close" (for printing from A & B rolls) can be made to occur on cue, during high speed printing from original negatives.

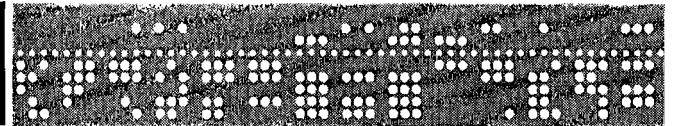
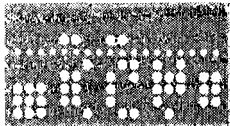

WITH SIMPLIFIED PROGRAMING OF COLOR CORRECTIONS

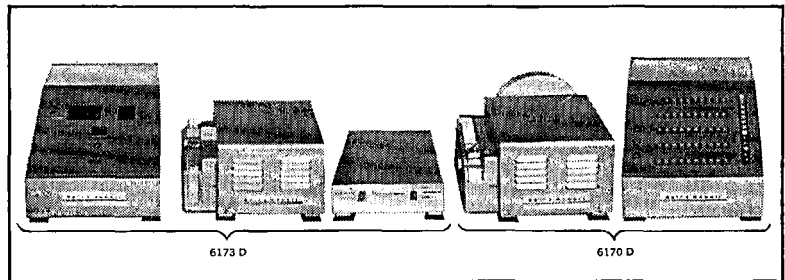

PUNCHED TAPE SYSTEMS GUARANTEES SPEED, ACCURACY AND CONSISTENT QUALITY

The color timer's instructions are easily translated onto standard punched tape, which is then used to control the light valves, and to run the entire printing process. Once the Bell & Howell Model "C" Additive Color Printer is threaded and the start button is pushed, this latest development in laboratory printing takes over at speeds up to 180 feet per minute. The results are identical release prints of better definition and accurate, crisp colors.

Design 6170-D, Program Tape Punch units, pre-program all scene-to-scene color changes, fade lengths of 16-24-32-48-64-96 frames, and zero close for extended scene printing. The checker-duplicator, design 6173-D, is used to verify the program and to make last minute corrections or additions in the tape.

*For more detailed information, please write or phone
J. L. Wassell, Director of Marketing
Professional Equipment Div., (312) ORchard 3-3300*

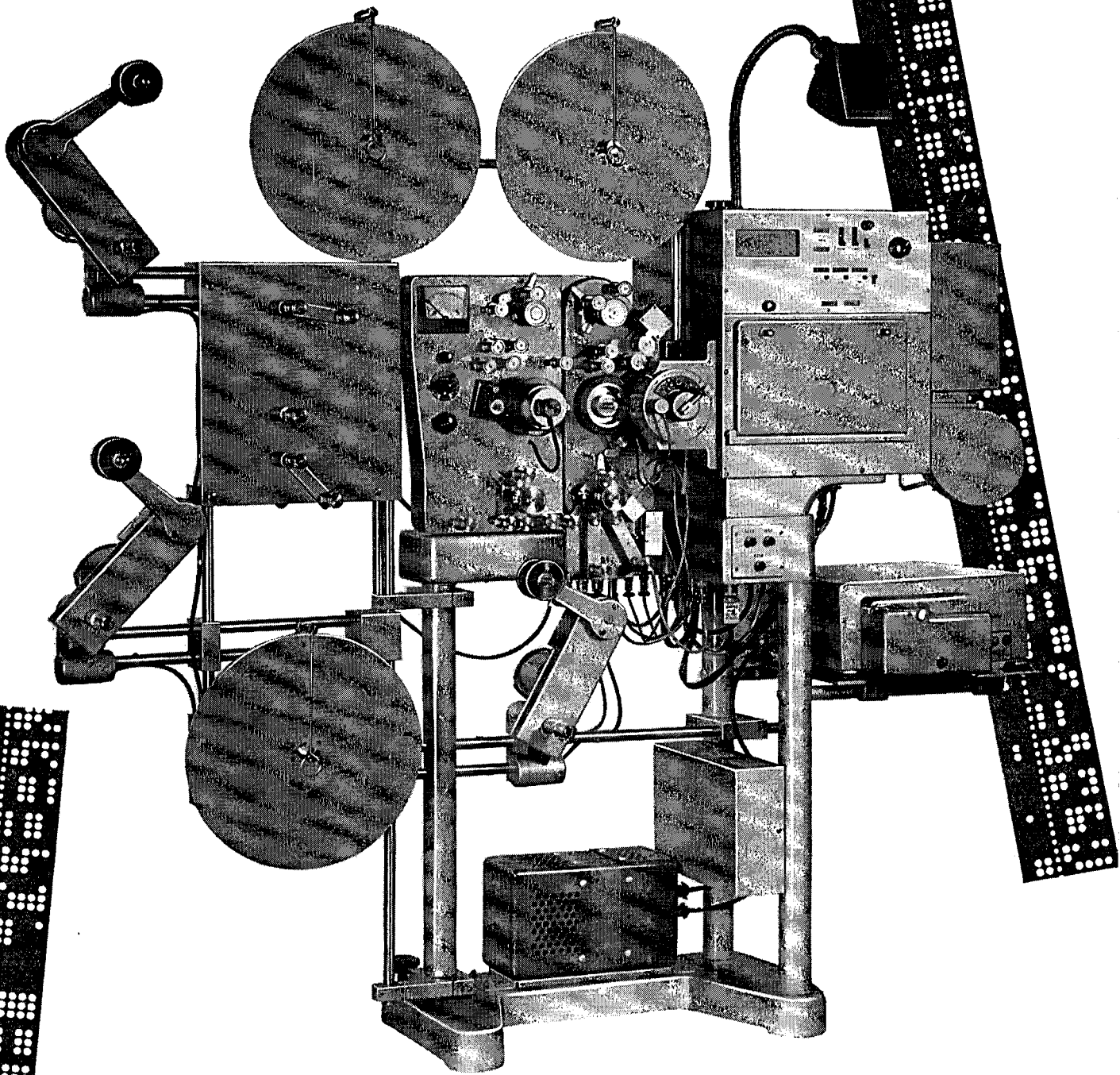

MODEL "C" FEATURES—Ability to make scene-to-scene color corrections . . . Six fade lengths (16-24-32-48-64-96) separately controllable by pre-punched program tape . . . Zero close to allow extended scene printing . . . Over 2000-foot capacity . . . Single 1000-watt lamp proximity reflector type . . . Edge light printing separately controlled at aperture . . . Instruments internally illuminated . . . RF cue system available as accessory to supplement standard notch cue . . . Slow-start circuit to prevent film damage . . . Internal air pressure . . . Pre-wired for sound head installation . . . Automatic stop in case of negative break.

ACCESSORIES—Tape checker-tape duplicator unit (6173C), 1000-watt rectifier (6160), RF cue kits (6395) and 16mm, 35mm, 35/32mm soundheads.

OTHER MODELS AVAILABLE—Model "MB" automatic high speed printer, for black and white or color printing (where scene-to-scene color corrections are not required). This model is pre-planned and pre-drilled for up-dating to the Model "C" at any time.

Both Model "C" and Model "MB" are available for the following sizes 16mm, 35mm, 35/32mm, 65/70mm, 70mm type I, and 70mm type II.

Demonstration Film Available

A three minute color sound film has been prepared demonstrating the additive color system of motion picture printing. Examples of color correction are shown, as well as demonstrations of the unique new light valves combined with tape controlled operation. To preview this film write or phone James L. Wassell, Director of Marketing, Bell & Howell Company, 7100 McCormick Road, Chicago, Illinois 60645, (312) OR 3-3300.

black-and-white originals, dupes and release prints; free consultation service.

Personnel: Michael Freedman, Jules Leni, Stanley Gitner and Jerry Mociuk.

Dage Television Co. Booth 21
455 Sheridan Ave., Michigan City, Ind.

Exhibiting: New 800-line horizontal resolution television camera with option of local or EIA remote-control operation, featuring complete transistorization except for preamplifier nuvistor and vidicon, 10mc video bandwidth; DV-200 portable video-tape recorder, permitting simultaneous recording of sight and sound and featuring variable-speed slow motion in both forward and reverse, average head life in excess of 5,000 hours. The introduction of the recorder and new instrumentation camera permits selection of a complete closed circuit television system from a single source.

Personnel: Frank Leins, Carl Hayworth, Stephen Ziff, Seymour Ziff, Carl Weininger, Jr., George Bemis, Norman Lucas.

Dalto Electronics Corp. Booth 34
38 Oak St., Norwood, N.J.

Exhibiting: Amphicon 200 Large-Screen Television Projector, including projection head, power control unit, a-c cable, sweep reversal capability, and manual; Amphicon 330 Color Television Projector (RGB/NTSC color and monochrome), complete with VHF/UHF tuner, test speaker, a-c cable and manual.

Personnel: Art R. Tucker, Richard Saylor, Carl H. Heydeman.

Andre Debrie of New York Booth 44, 45
14-29 112th St., College Point 56, N.Y.

Exhibiting: Andre Debrie Optical Printers; Andre Debrie Double Band Projector; Andre Debrie XN Wall Mount Projector; Andre Debrie Auxiliary 16mm Projector (for conversion of 35mm Proj.); Andre Debrie Daylight Processor "Aiglonne America"; Sonocolor all-format Magnetic Striping Machine SCF2.

Personnel: R. J. Harrington, C. Feuerbach, M. Nanocchio

DuKane Corp. Booth 14
St. Charles, Illinois

Exhibiting: Sound filmstrip projectors, filmstrip viewers and continuous flow filmstrip projectors.

Personnel: Howard V. Turner, John Lord, Bob English.

Eclair Corp. of America Booth 61
7262 Melrose Ave., Los Angeles, Calif.

Exhibiting: Camerette 35mm Camera with techniscope or normal (4 perforation) operation immediately interchangeable; Eclair NPR 16mm Camera; Perfectone recorders.

Personnel: J. P. Carson

Carlos H. Elmer Booth 38, 39
Box 876, Scottsdale, Arizona

Exhibiting: Photo-Sonics high-speed motion-picture cameras; Richardson motion-picture film projectors for 70mm, 35mm, and 16mm film; Traid 16mm and 35mm air-

borne motion-picture cameras; Vanguard motion analyzers.

Personnel: Carlos H. Elmer.

"EUMIG" Elektrizitäts- und Metallwaren-Industrie Booth 23
Buchengasse 11-15, Vienna, Austria

Exhibiting: New Eumig Mark-S 8mm Sound Projector, with automatic volume control, automatic mixing, quartz-iodine lamp, zoom lens (1 : 1.3, focal length 13 — 25mm), designed for simplicity of servicing.

Personnel: Oskar Jursa.

F&B/Ceco, Inc. Booth 9, 10, 11, 12
315 West 43 St., New York, N.Y. 10036

Exhibiting: F&B/Ceco Super Silent Auricon Conversion; Eyemo Reflex Camera; Filmo Reflex Camera; BNC Reflex Camera; Eclair Camera; # 9100 Tape Splicer; Professional Jr. Tripods; Balanced TV Heads; 16mm F&B/Ceco Viewer; 35mm F&B/Ceco Viewer; Professional Jr. Fluid Head Tripod; F&B/Ceco Editing Tables; Elemack Spider Dolly; Sancine Shoulder Pod; Bauer Xenon Projector; E. K. Reflex Camera Accessories.

Personnel: Arthur Florman, John Babb, Leonard Hollander Dom Notto, Lou Girola, Wallace Robbins, Leonard Dickstein, Oliver E. Cain.

Fairchild Camera and Instrument Corp. Booth 49
221 Fairchild Ave., Plainview, L. I., N.Y.

Exhibiting: Projectors—AV 400, Mark IV and Mark V; also, film cartridge, MoviePak used in Mark IV and Mark V.

Personnel: Steven Greene, Carl Flint, Nat Myers.

Filmline Corp. Booths 62, 63
Erna St., Milford, Conn.

Exhibiting: New Filmline FE-30 Color Processor, designed to process all Ektachrome film using the Kodak formulation, as well as ME-4 and black-and-white film, at speeds infinitely variable up to 60 ft/min., with daylight operation, stainless steel, temperature controlled, impingement dry-box, air compressor, take-up and feed-in elevators, dial thermometers for solution temperatures and drybox temperatures, recirculation pumps, individual bottom drains and valves on all tanks, Filmline overdrive system, etc.; ND-100, fast, portable negative processor for speeds up to 80 ft/min with dry-to-dry cycle of 3½ min, as used by ABC-TV, NBC-TV and CBS-TV; Filmline's new 200 ft/min spray processor for 16 or 35mm film.

Personnel: Edward B. Krause, John Koteas, John Grady.

Frigidheat Industries, Inc. Booth 28
P.O. Box 6037, Nashville, Tenn. 37212

Exhibiting: Thermal Unit Model 60A-12 designed for the largest processors to maintain temperature of photo chemicals with a tolerance of 1/10 degree.

Personnel: J. O. Ewing, W. C. Elliott.

General Camera Corp. Booth 22
723 Seventh Ave., New York, N.Y. 10019

Exhibiting: Mitchell R-35 "Top Conversion" with accessories; Mitchell NC "Reflex" with special lens mount; Eyemo "Reflex" with special lens mount; General Camera

"Super Sync" CineVoice Conversion; Electric motor drive for 25/250, Angenieux zoom lens; special mattebox for R-35; 24/240, Angenieux zoom lens with finder for BNC.

Personnel: Richard DiBona, Ann DiBona, Milton Keslow, Walter Druker.

The Harwald Company Booth 58
1245 Chicago Ave., Evanston, Ill.

Personnel: Robert Grunwald, Richard Wallace.

Heico, Inc. Booth 27
25-27 N. Sixth St., Stroudsburg, Pa.

Exhibiting: Heico Rezinators—micro—filtration of photographic processing waters for the removal of insolubles down to .5 microns.

Personnel: H. E. Ingraham, T. E. Ingraham.

Karl Heitz, Inc. Booth 13
979 Third Ave., New York, N.Y. 10022

Exhibiting: Kinoptik Apochromatic movie and TV lenses from extreme 1.0mm f/1.9 wide angle (197°) up to super telephoto 1000mm; Alpa 35mm single-lens reflex with electronically compensated optically coupled exposure meter behind lens, with 5 Apochromats, 10 fully automatic lenses, others up to 5000mm; Tessina 35mm motorized twin-lens reflex subminiature camera; Robot 35mm motorized cameras with complete electro-magnetic photo-recording systems, oscilloscopic, streak, microscope, document/portrait cameras, and Microfilm Reader-Projector; Sinar Automatic Viewcamera: 8×10—5×7—4×5; Camex 8mm single-lens reflex movie camera with behind-the-lens exposure meter, interchangeable zoom and individual lenses up to 360mm; Lindia 2×2 De-Luxe Snap-in Mounts; Volomat and Densitocolor enlarging exposure meters; Fi-Cord portable tape recorders and dictating equipment.

Personnel: Ben Zale, George Schenk, Sid Rosen, Yvonne Brandes, Marion Schlappfer.

Hi-Speed Equipment, Inc. Booth 68
73 Pond Street, Waltham, Mass. 02154

Exhibiting: Colored transparencies of processors for handling positive-negative 16/35mm or 16/70mm black-and-white film as well as for negative-positive color equipment—Kodachrome, Ektachrome, or Anscochrome installations. Pictures of the complete line of Hi-Speed equipment for the photographic laboratory will also be available showing: Custom Photographic Processing Equipment—Silver Recovery Systems and Laboratory Engineering Service.

Personnel: James Donovan, Victor Takata, Bertram G. Gade, William H. Groves, Alex Bagdasarian, Ralph T. Joje.

Hollywood Film Co. Booth 40
956 N. Seward St., Hollywood, Calif. 90038
524 West 43 St., New York, N.Y. 10036

Exhibiting: 70mm Repari Splicers; High Speed Inspection Projectors with picture and sound; Edge Numbering Machine; Projector Editor; Diazo Printer; Radio Fre-

quency Cue Detectors for Printers and automated projection.

Personnel: Harry Teitelbaum, Sheldon Kaplan, George Blackhall.

MGM Telestudios, Inc. Booth 48
550 Fifth Ave., New York, N.Y. 10036

Exhibiting: Gemini Tape Film System—Gemini is a video tape system which produces a simultaneous direct 16mm film during video-tape production. This device uses 16mm camera units, mechanically and optically coupled to the TV camera. Gemini includes the "Edilite" editing device which marks the 16mm film while the camera is being "taken." MGM Video-Tape Editing System—This system of machines permits precise and rapid editing and mixing of video tape. A dubber unit feeds timing signals to the tape cue tract. An editing unit is used to program cutting information on to synched log strips. The tape deck unit is used to physically edit the original video tape.

Personnel: Warren Smith, Stanley J. Parnas.

Macbeth Corp. and Subs. Booth 46
P.O. Box 950, Newburgh, N.Y. 12553

Exhibiting: The latest in the Osram line of lamps, including the xenon series used in projection equipment and for space simulation projects, plus the Osram Mercury series and the X00 long arc xenon lamps which are lighting the 30' by 35' pictures at the Eastman Kodak Pavilion at the World's Fair. Also the new additions to the family of Macbeth QuantaLog densitometers... the new 200 series, including Status M filters for motion picture printing, the new microfilm densitometer, the new motion-picture soundtrack densitometer and the process control unit for Kodachrome film and others supplied with calibrated Kodak Status A-58 glass filters.

Personnel: W. B. Reese, F. McCurdy, P. A. Jensen H. Ellis, R. D. Lattin.

Machtronics, Inc. Booth 5
470 San Antonio Rd., Palo Alto, Calif. 94306

Exhibiting: The Machtronics MVR 15 Portable Broadcast Television Tape Recorder. This unit is a broadcast quality recorder designed to be used as either a portable, mobile or fixed station recorder. The recorder requires only 395 watts of power, and contains two 10 kc audio channels as standard equipment, each of which accepts input signals from either balanced lines at normal level, or low level microphones at any one of the standard impedances. Remote control of all transport functions is included as standard equipment.

Personnel: Kurt R. Machein, Frank Gonzalez, Don Horstkorta.

Magnasync Corporation Booth 70
5547 Satsuma Ave., North Hollywood, Calif.

Exhibiting: Magnetic film sound recorders/reproducers for motion picture production in 16mm, 17½mm, and 35mm; complete magnetic film dubbing/interlock equipment with looping facilities; studio multi-channel microphone and line mixing G963 Consolette.

Personnel: Bob Dickinson, Les Wayman.

Magna-Tech Electronic Co., Inc. Booth 3
630 Ninth Ave., New York, N.Y. 10036

Exhibiting: Motion picture sound recording and projection equipment.

Personnel: Otto Popelka, Norman Prisament, Bud Legreid.

Metro/Kalvar, Inc. Booth 15
550 Fifth Ave., New York, N.Y. 10036

Exhibiting: The new Metro/Kalvar 16mm dual-head motion-picture printer-processor, producing black-and-white television release prints in one continuous operation and in normal room light.

Personnel: N. R. Bacon, R. B. Lindemeyer, W. I. Vance.

Motion Picture Enterprises, Inc. Booth 20
Tarrytown 83, N.Y.

Exhibiting: Film reels, cans and shipping cases; projection lamps; video-tape reels; professional editing and laboratory equipment; Marquet splicers; Motion Picture, TV & Theatre Directory-wall chart and hand guide.

Personnel: Herbert R. Pilzer, Sylvia Jarvis, Elaine George.

National Cine Equipment, Inc. Booth 56
209 West 48th St., New York, N.Y. 10036

Exhibiting: Wall 35mm Reflex Camera; Eastman Reflex Cameras with accessories by National Cine Equipment; Bausch & Lomb Super Baltar Lenses; New National Cine Heavy-Duty HydroFluid Tripod for 35mm cameras; National Cine line of tripods and accessories.

Personnel: Bert Day, Tom Von Vertloh, Roger Menard, John Clemens, Erwin G. Harwood.

Neumade Products, Inc. Booth 53
250 West 57th Street, New York, N.Y. 10019

Exhibiting: Film editing, handling, and accessory equipment including hand and power rewinds; Super "X" rewind,

splicers, synchronizers, measuring machines, etc.; storage facilities for film, filmstrips, slides, video tape, disc records, audio tap; imprinted emulsion-free colored film leader.

Personnel: L. E. Jones, L. V. Grofsik, W. W. Clements, R. Neu Jones, R. E. Hempel.

Novatech Corp. Booth 69
282 Seventh Ave., New York, N.Y. 10001

Exhibiting: New NTS Nova Twin, featuring instantaneous push-button interchangeable reflector assemblies, and other reflector assemblies for conversion of Nova Twin from narrow spot to broad flood; Nova Lite ultra-compact light-weight unit with adjustable focus, with variable control permitting range from medium through broad flood; new accessories for Nova Twin and Nova Lite.

Personnel: Harold Kovner, Bernard Block, John Utley, Roscoe Farmer, Peter McReavy.

Oxberry Corp. Booth 60
620 Fayette Ave., Mamaroneck, N.Y.

Personnel: Edward J. Willette, Jack Sobelicht, Ralph D. Whitmore.

F & B/CECO I N C.

WELCOMES

SMPTE CONVENTIONEERS!

You'll meet a lot of us at our booths (#9, #10, #11, #12), and the rest of the gang will welcome you to our headquarters on West 43rd Street. We'd like to show you our showrooms and shops because we think F & B/CECO has the **best** facilities for Serving the World's Finest Film Makers.

F & B/CECO I N C.



315 West 43rd Street,
N. Y., N. Y. 10036
JUdson 6-1420

Paillard, Inc. Booth 6
1900 Lower Road, Linden, N.J.

Exhibiting: Bolex 16mm cameras; 16mm zoom lenses; Bolex 16mm camera with automatic exposure control; Hasselblad still cameras; Bolex H-8 cameras.

Personnel: Fred Onderka, Ernst Wildi.

Photo Lectronic Research, Inc. Booth 50
141 West 42 St., New York, N.Y.

Exhibiting: New North Light System, an integrated assembly of Quartz, Incandescent, Reflectal (collapsible, folding metal reflector). The quad delivers 500 ft-c at 10 ft covering 11 ft across, 60° BA; indirect for shadowless lighting delivers 219 ft-c at 10 ft covering 16 ft across, 80° BA; direct but diffused delivers 438 ft-c.

Personnel: J. A. Johnson.

Plastic Reel Corp. of America Booth 47
612 Boulevard East, Weehawken, N.J.

Exhibiting: 8mm film reels 50 ft thru 1200 ft sizes; 16mm Pilo Magic film reels 50 ft thru 2200 ft; processing rollers and bearings; film cores-8mm-16mm-35mm; Plio Magic film shipping cases; Reel-Paks, Reel & Can Combinations, 8mm 50 ft-thru 400 ft, 16mm 50 ft thru 400 ft; tape reels, all sizes 2 in thru 7 in.

Personnel: Milton Blutter, Allen Braverman.

Precision Laboratories Div. Booth 55
928-930 East 51 St., Brooklyn 3, N.Y.

Exhibiting: Precision sound Readers, optical and magnetic;

Precision Unitized Synchronizers; power film slitters; film slitter and editing equipment; editing tables.

Personnel: Irwin R. Sheldon.

Quick-Set, Inc. Booth 7, 8
8121 Central Park, Skokie, Ill.

Exhibiting: New models Gibraltar Cradle Heads for movie and TV work, new vibration-free dollies with special jack screws for lifting wheels off the floor; standard line of Super Quick-Set-Samson, Hercules, Gibraltar, a complete line of tripods, panheads, dollies, etc. for photo, television, remote control, high-speed or instrumentation usage, capable of handling loads from 5 to 200 lb. on panheads and elevators, and 500 lb. on tripods, including $\frac{3}{4}$ and full-length, with or without elevators, panheads incorporating friction and/or geared controls; power and hand-operated pedestals and consoles; accessories include Pelco Adapters, special apparatus for easier attachment of heavy cameras, and Lo-Hi units.

Personnel: A. J. Briglia.

Roanwell Corp. Booth 64
180 Varick St., New York, N.Y.

Exhibiting: TV studio headsets—TV cameramen's headsets; boom-men's cue phones; RF cameramen's headsets; commentators' headsets and boom-mounted microphones. Noise-canceling telephone transmitters.

Personnel: Metro P. Sirko, Martin L. Levie, Vincent C. Gelso, Malcolm D. Green, Robert T. Ennis, Marvin R. Payne, Paul R. Terranova, John F. Moriarty, W. J. Novelli, Miss E. S. Ratuszny.

VANGUARD MEASURING MACHINES

FOR BUBBLE CHAMBER AND SPARK CHAMBER FILM MEASURING IN HIGH ENERGY PARTICLE PHYSICS AND OTHER RESEARCH FILM



- THE MEDIUM—PRECISION MEASURING MACHINE READS OUT X-Y COORDINATES IN .0001 INCH INCREMENTS.
- THE PRECISION MEASURING MACHINE READS OUT X-Y IN ONE MICRON INCREMENTS.
- BOTH MACHINES HANDLE 35MM AND 70MM, THREE FILM STRIP RECORDS AND SINGLE STRIP 46MM THREE VIEW RECORDS.

VANGUARD film measuring and reading equipment is in use in laboratories throughout the world. Other related types of equipment for this field are available.

WRITE FOR CATALOG M64

VANGUARD INSTRUMENT CORPORATION
20 W. Centennial Ave., Roosevelt, N.Y. (516) FReeport 8-8070

EQUIPMENT EXHIBIT

See the newest advances in equipment for

cinematography - instrumentation and high-speed
 photography - laboratory practice - medical motion
 pictures and television - motion pictures and television
 for education - optics and special effects - television
 engineering and production - 8mm and small-format
 films - space technology - sound recording

EXHIBIT OPEN Sept. 28-Oct. 1, 1964

BOOTHS 1-12, 15-18, 23-26	\$325
<i>(ceiling height, rear 3 ft of booth, 7' 10")</i>	
BOOTHS 13, 14, 27, 28	\$300
<i>(ceiling height 7' 10")</i>	
BOOTHS 19-22, 29-70	\$350

Less 10% for SMPTE Sustaining Members

Reservations for booths are now being made by the Exhibit Chairman:
 Dominick J. Capano, S.O.S. Photo-Cine-Optics, Inc., 387 Park Ave. South,
 New York, N.Y. 10016



TECHNICAL
 CONFERENCE
 AND EXHIBIT

Commodore Hotel,
 New York City

September 28 -
 October 1, 1964

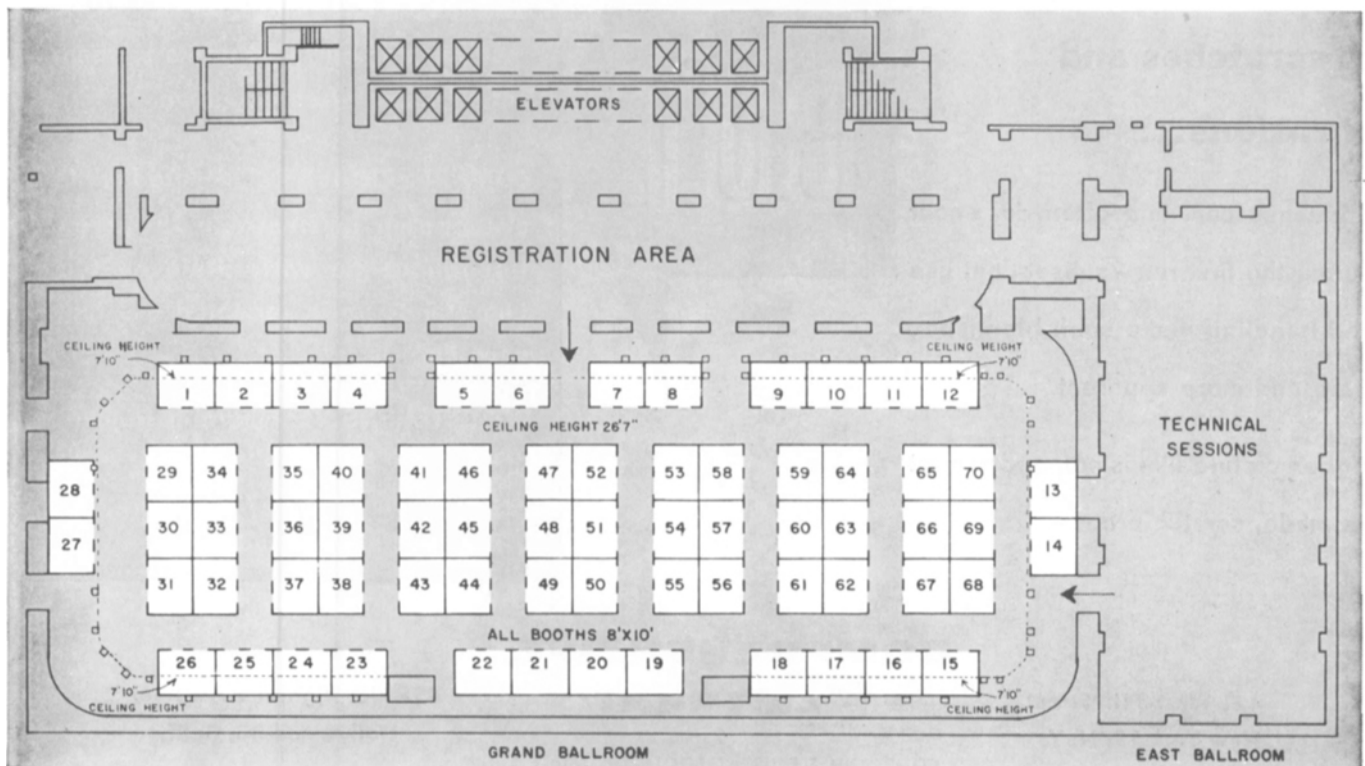

3M Co./Revere-Wollensak Div.
850 Hudson Ave., Rochester, N.Y. 14621

Booth 1

Exhibiting: High-speed photographic cameras; Mirratel Catadioptric Lens Systems; photoinstrumentation products; radar boresights, 40-8 in. Dual Lens System, 80 in. Dual Camera System.

Personnel: Fred M. Emens, Edward Wollensak, Jack Kronemyer.

S.O.S. Photo-Cine-Optics, Inc.
387 Park Ave. South, New York, N.Y. 10016

Booth 54

Exhibiting: S.O.S. Ediola Model AO Viewer, with optical sound reader; S.O.S. Projectola; Moy Edge-Numbering Machine; TG Titler and accessories; S.O.S. Tel-Amatic Microphone Mixer; S.O.S. Transistosound Amplifier; horizontal storage film cabinets; Angenieux zoom lens; portable power supply; film splicers; S.O.S. Hot Press and accessories; O'Connor Fluid Head; S.O.S. Junior Tripods and Triangles.

Personnel: Alan C. Macauley, Jan T. Macauley, Dominick J. Capano, Arnold Nappi.

Sylvania Electric Products, Inc.
730 Third Ave., New York, N.Y. 10017

Booth 29, 30

Exhibiting: New Precision Light Model Q-2, introduced at the Los Angeles SMPTE Conference in April. A new quartz iodine lamp design incorporated with a new reflector design now makes possible this new rugged, compact, lightweight economical studio unit with constant light output and precise color temperature control. Also shown will be Sylvania's new Model 30V Portable Sun Gun and lightweight Model SG-63 Sun Gun and accessories.

Personnel: E. A. Gilchrist, Al Gordon, James O'Hara.

**ALL FILM
IS SUSCEPTIBLE
to scratches and
abrasions...**

Scratches can, and often do, occur during the first run—subsequent use and handling make such blemishes more and more apparent.

Motion picture film is not, and cannot be made, scratch-proof—



BUT

COMPREHENSIVE FILMTREAT REJUVENATION

restores originals and prints to their initial, scratch-free condition.

COMPREHENSIVE Rejuvenated prints are shown in first-run theatres throughout the world. Rejuvenated film stands up in repeated use like new film.

COMPREHENSIVE Filmtreat Rejuvenation costs you so little, saves you so much.

Write for literature and prices.

421 West 54th Street,
New York 19, N. Y.

**COMPREHENSIVE
FILMTREAT**

COME AND SEE US AT BOOTH 59, SMPTE SHOW

829 No. Highland Avenue,
Hollywood 38, Calif.

August 1964 Journal of the SMPTE Volume 73

OXBERRY LEADS THE WAY with a major breakthrough in Optical Printers!

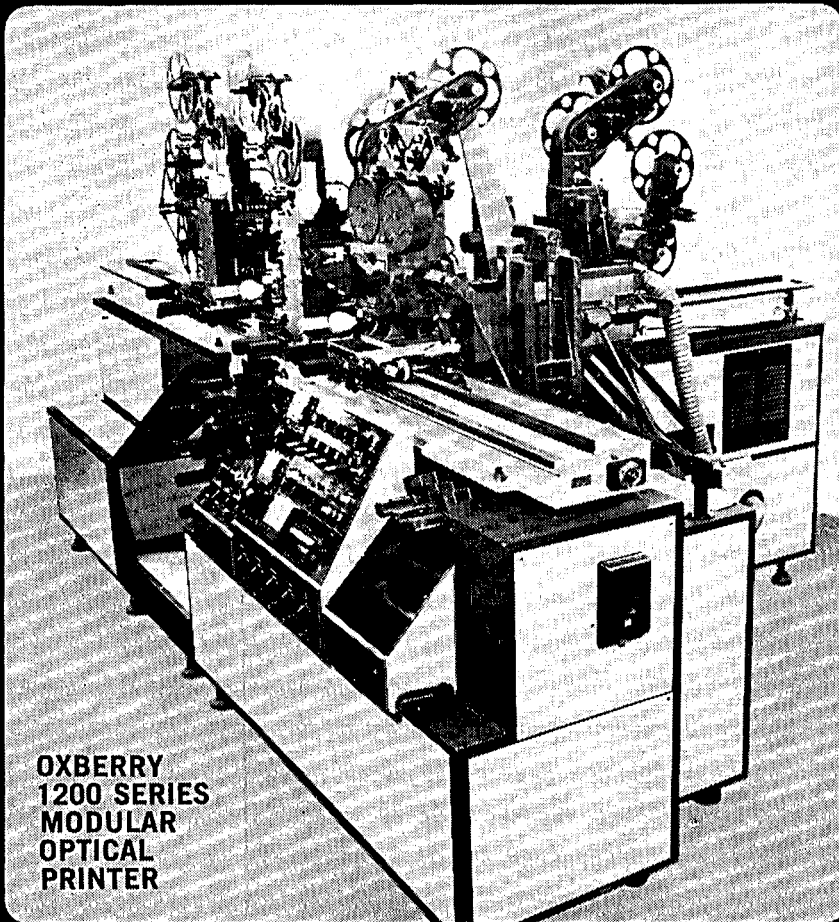

**OXBERRY
1200 SERIES
MODULAR
OPTICAL
PRINTER**

- Modular concept permits many major features to be on 1 printer!
- 60" flat cast iron bed for rock-steady stability —allows greater enlargement and reduction!
- Built with 1 thru 4 projector heads!
- Patented Aerial Image and Beam-Splitter Aerial Image projectors with 3 dia. enlargement thru 1:1 to 4 dia. reduction—allows combining 35, 16 and Cinemascope in a single pass!
- Full Aerial Image scope of over 30 diameters with camera!
- Tilt facilities enable any scene in any projector head to be straightened!
- Choice of three auto-focus systems available, permitting focusing through 1:1!
- Modular system receives 65 and military 70mm cameras and projectors!

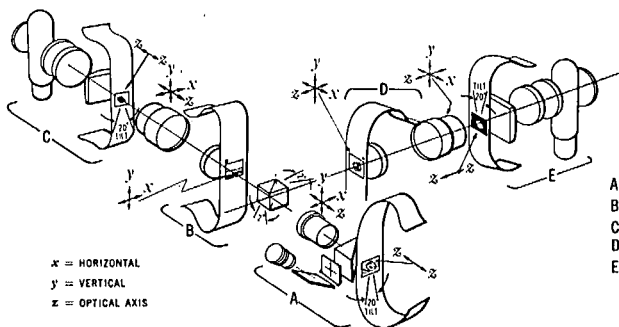
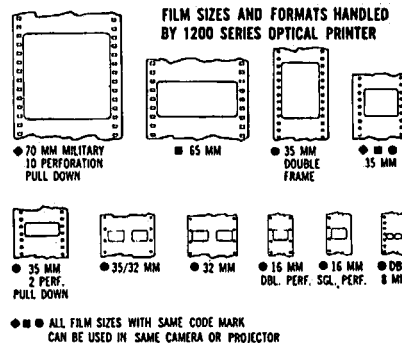

THE MODULAR SYSTEM OF CONSTRUCTION PERMITS MAJOR FEATURES TO BE ADDED AT ANY TIME — ELIMINATES BUILT-IN OBSOLESCENCE!

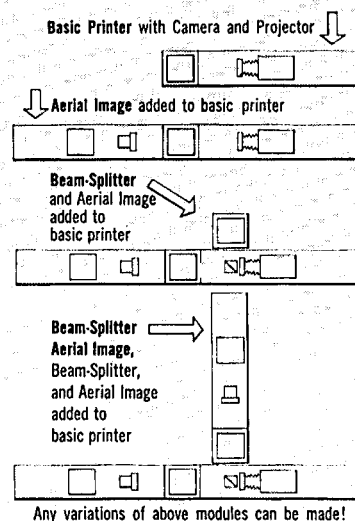

For further information, write on company letterhead to:

OXBERRY CORPORATION*
620 Fayette Avenue, Mamaroneck, New York
Telephone (914) 698-9400

World-wide sales and service facilities

Offices:

7445½ Sunset Boulevard
Hollywood, California 90046
Telephone (213) 876-2140

515 Ipswich Road
Slough, Bucks, England
Telephone Slough 2-9666

*Formerly The Animation Equipment Corporation