



Dimensions of 35-mm Motion-Picture Rewind Spindles

1. Scope

This practice specifies the dimensions of 5/16- and 1/2-in 35-mm motion-picture rewind spindles.

2. Dimensions

The dimensions shall be as given in the figures and table.

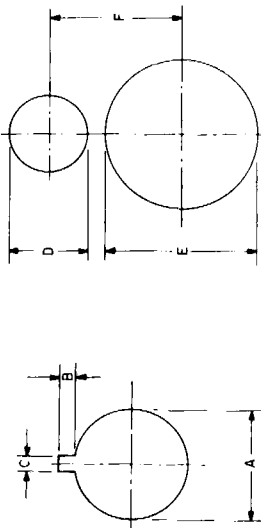

Fig. 1
5/16-in Spindle

Fig. 2
1/2-in Spindle

Dimensions	Inches	Millimeters
A	0.315 + 0.000 - 0.005	8.00 + 0.00 - 0.13
B	0.120 ± 0.010	3.05 ± 0.25
C	0.120 ± 0.010	3.05 ± 0.25
D	0.250 ± 0.010	6.35 ± 0.25
E	0.500 + 0.000 - 0.008	12.70 + 0.00 - 0.20
F	0.782 ± 0.010	19.86 ± 0.25

3. Related American National Standards

Dimensions of reels which are likely to be used on the rewinds described in this practice are specified in the following American National Standards:

Projection Reels

Motion-Picture Equipment — 35- and 70-mm Projection Reels, ANSI PH22.4-1983

Motion-Picture Equipment (16-mm) — Projection Reels — 200- to 2300-Ft Capacity, ANSI/SMPTE 235-1987

Camera Spools

Dimensions for 16mm 100-Foot, 16mm 200-Foot, 35mm 100-Foot, and 70mm 100-Foot Spools for Recording Instruments, Microfilms and Still-Picture Cameras, ANSI PH1.33-1986

Shipping Reels

Motion-Picture Equipment — Shipping Reels for 35-mm Prints, ANSI/SMPTE 192-1985

Cinematography — Labelling of containers for motion-picture film and magnetic materials — Minimum information for exchange of materials

1 Scope and field of application

This International Standard specifies the information to be included on the label and/or accompanying documents, for identifying the contents of containers for processed motion-picture films and magnetic sound records.

NOTE — It does not apply to labelling of containers of unexposed motion-picture films and magnetic materials specified in ISO 3042.

This International Standard also specifies the abbreviations which may be used for designation.

- d) language version;
- e) copy number;
- f) reel number;
- g) total number of reels.

3.1.2 If the print has standard characteristics, no other information need be given, but variations shall be specified as follows:

2 Reference

ISO 3042, Cinematography — Labelling of containers for unexposed motion-picture films and magnetic films — Minimum information specifications.

ISO 3640, Cinematography — Motion-picture prints and sound records for international exchange of television programmes — Specifications.

3 Label or document information

The information required on the label of the container (can or carton, etc.) or on the document accompanying it, depends on the type of film to be identified. The types of film are

- a) release prints other than those intended for television use;
- b) prints for television;
- c) all types of processed motion-picture film and magnetic sound records except prints.

3.1 Release prints other than those intended for television use

3.1.1 The following information shall be given:

- a) company or organization name, address, telephone number;
- b) title of film;
- c) film gauge (width);

Standard characteristics (need not be specified)

- Tri-acetate base (support)
- Positive perforations and pitch
- Coloured image
- Rectilinear (flat) image requiring spherical projection lens
- Wide screen presentation for 35 mm
- Projection speed 24 frames per second
- Mono optical sound

Specify

- Polyester base (support)
- Negative-perforations and pitch
- Black-and-white image
- Anamorphic image
- 16, 18, 25 frames per second
- Stereophonic, magnetic, etc.
- Emulsion orientation (16 mm prints only)

3.2 Prints for television

The following information shall be given for the interchange of prints for television. (See ISO 3640 for definition of identification codes.)

3.2.1 Non-technical information:

- a) name, address, telephone number of originating company or organization (1);
- b) name of originating department (2);
- c) date of packing (3).

3.2.2 Technical information :

- a) special information (not specified below) (4) ;
- b) type of film stock (5) :
 - colour (C)
 - black-and-white (B)
 - magnetic (M)
- c) film gauge (width) (6) :
- d) type of sound (7) :
 - separate magnetic track (SEPMAG)
 - combined picture and magnetic track (COMMAG)
 - combined picture and optical track (COMOPT)
 - no track (MUTE)
- e) emulsion orientation (8) :
- f) position and contents of SEPMAG tracks (9) :
- g) duration of the reel in minutes and seconds at 24 frames per second (10) .
- h) duration of the reel in minutes and seconds at 25 frames per second (11) :

3.2.3 Content information :

- a) programme registration number (12) ;
- b) copy number (13) ;
- c) title of the film programme, or series of programmes (14) ;
- d) number and title of the episode if applicable (15) ;
- e) reel number (16) ;
- f) total number of reels in the film or episode (17) .

3.3 All types of processed motion-picture film and magnetic sound records except prints

This sub-clause covers all of those materials which may be used in making a motion-picture film up to, but not including, the print.

- original picture negative;
- intermediate positive (master positive);
- duplicate negative;
- colour reversal internegative (CRI);
- sound track negative;
- magnetic masters, etc.

The following information shall be given :

- company or organization name, address, telephone number;
- film type : original negative, CRI, magnetic track, etc., preferably in large letters on a colour coded background;
- title;
- episode (if applicable);
- reel number and total number of reels;
- length of film on that reel;
- version (language, long, short, television, etc.);
- film gauge (width) and format (rectilinear or anamorphic image);
- perforation type and pitch;
- base (support);
- emulsion orientation.

Annex

Additional data

(This annex does not form part of the Standard.)

The European Broadcasting Union technical document EBU 3211-E describes a label, shown in the figure, for the exchange of television programmes on film.

Sub-clause 3.2 of this International Standard is based on EBU 3211-E.

NOTE — References to the relevant items in 3.2 are given in the figure by encircled numbers.

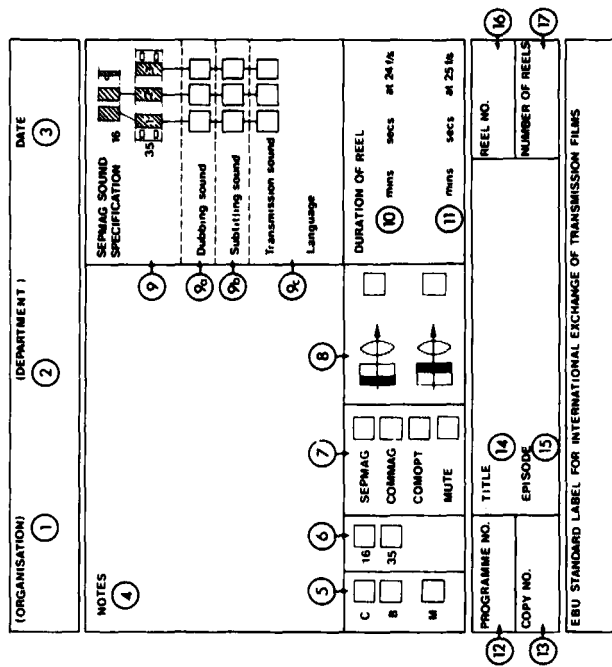

Figure — Label for television prints